

Guide to Assembly & Usage

Dual Handle Open Ended Platform Trolley



Information

If in doubt, contact the supplier



Read this Guide thoroughly before commencing assembly & retain for future reference



Before commencing assembly, unpack carefully & check that all components ordered are included



Tools – 17mm Spanner



Caution

During assembly, ensure to:



Take care during assembly & in use, particularly when lifting or stretching & when using tools



Wear suitable protective clothing - protective gloves and footwear are recommended



Assemble & locate for use on a suitable level floor surface. Allow adequate working space



Dispose of packaging materials responsibly



Warning

Rules for the safe use of shelving:



Ensure these instructions are retained for reference & that users are aware of the rules for safe use



NEVER CLIMB ON THE STRUCTURE OR STAND ON THE TROLLEYS



DO NOT USE IN DAMP OR WET CONDITIONS



LOAD HEAVY ITEMS ON THE LOWER SHELVES & LIGHTER ITEMS ON THE HIGHER SHELVES







ENSURE THAT THE MAXIMUM LOAD CARRYING CAPACITIES ARE NOT EXCEEDED



PLEASE REFER TO THE LOADING CHART SUPPLIED FOR DETAILS



COMPONENT CHECK LIST

Component	Quantity	Code
Base 	1	WPRBASE
Handle 	2/4	SP-WPR7
Bolt 	1 per handle	SP-WPRBOLT
Washer 	1 per handle	SP-WPRWASHER

If you have any missing components please take note of the part name, colour and code and contact your supplier

Dual Handle Open Ended Platform Trolley Assembly

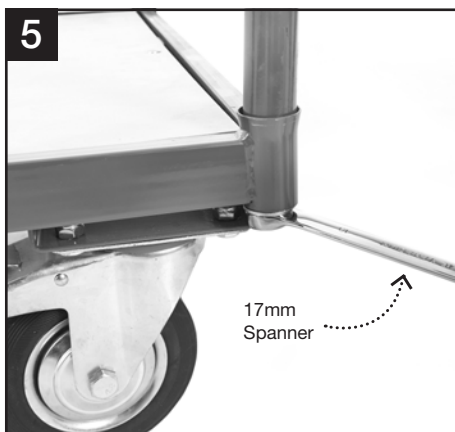
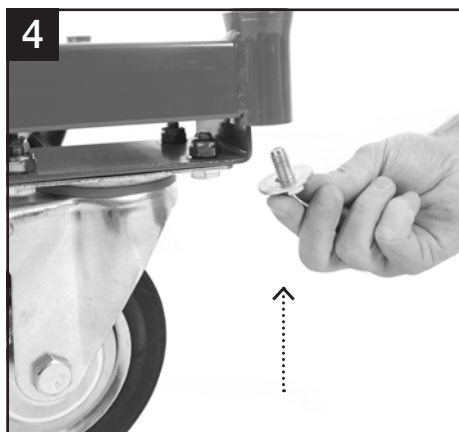
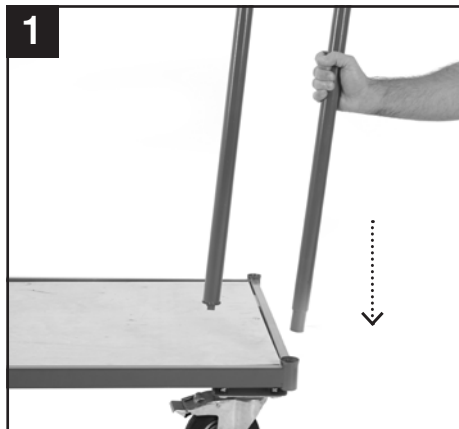

WPR BASE LOADING CHART	
Max load	Weight in kilograms
Per base	500KG UDL

All weight loadings relate to UDL (Uniformly Distributed Loads).